

Q-railing Handrail Brackets for Glass G316

HANDRAIL BRACKETS

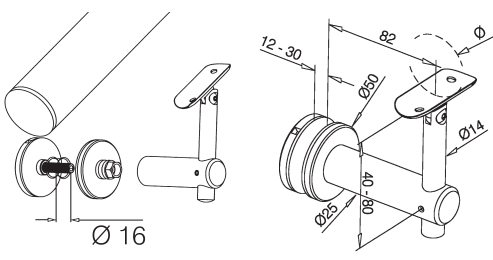

CODE	HANDRAIL FIXING	ADJUSTABLE TOP
AN-140150-000	Flat	No
AN-140150-048	Round 50mm	No
AN-140150-048MP	Round 50mm	No
AN-140150-060	Round 60mm	No
AN-140155-000	Flat	Yes
AN-140155-048	Round 50mm	Yes
AN-140155-048MP	Round 50mm	Yes
AN-140155-060	Round 60mm	Yes

MP = Metal Polished

This bracket is for fixing to glass, the two round plates and rubbers found at the back of the bracket unscrew to allow the centre bolt to go through a pre drilled hole in the glass. Then you simply screw the plates together until tight. The height of the arm is easily adjusted with the grub screw (1a and 1b). The handrail can then be screwed or riveted on. Available in straight or adjustable for stairwells etc.

